

EXTRA LARGE MEETING ROOMS

Storsal A+ B, IMI Forum

Area: 1020 m²

Capacity: 1327 pax

Set up: Cinema

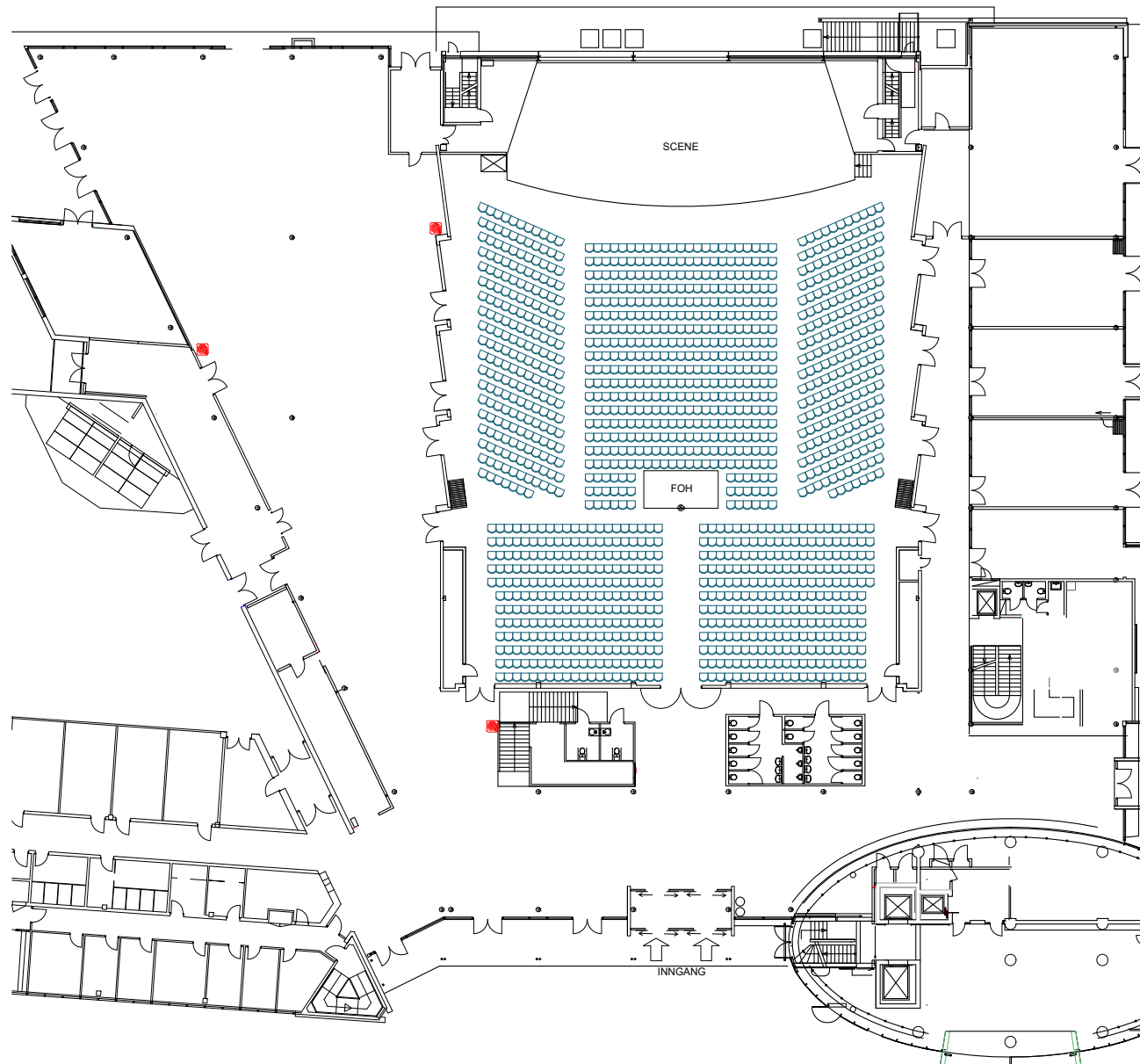

EXTRA LARGE MEETING ROOMS

Storsal A+ B, IMI Forum

Area: 1020 m²

Capacity: 286 pax

Set up: Cinema - Corona

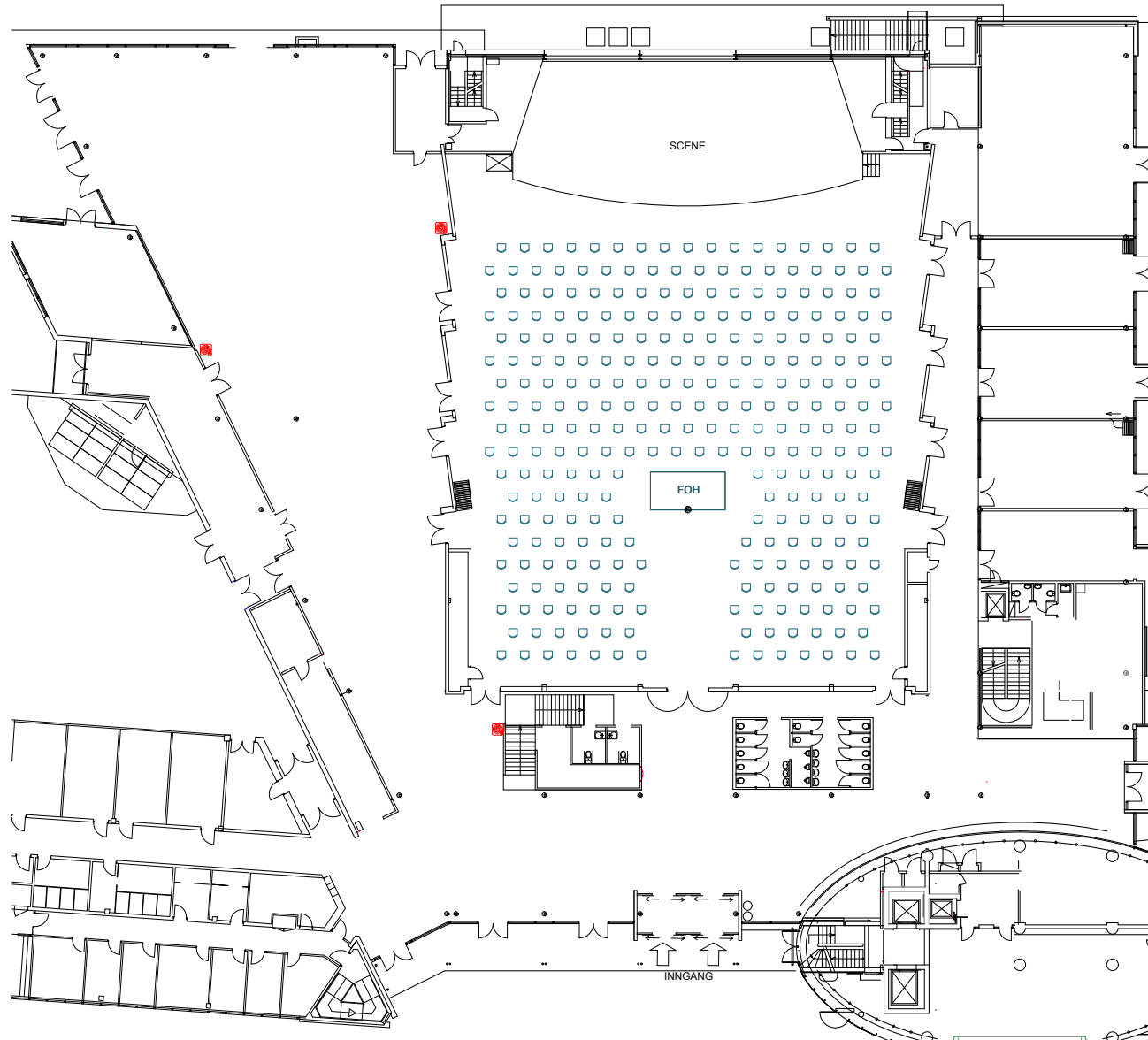

EXTRA LARGE MEETING ROOMS

Storsal A+ B, IMI Forum

Area: 1020 m²

Capacity: 864 pax

Set up: Rectangular tables

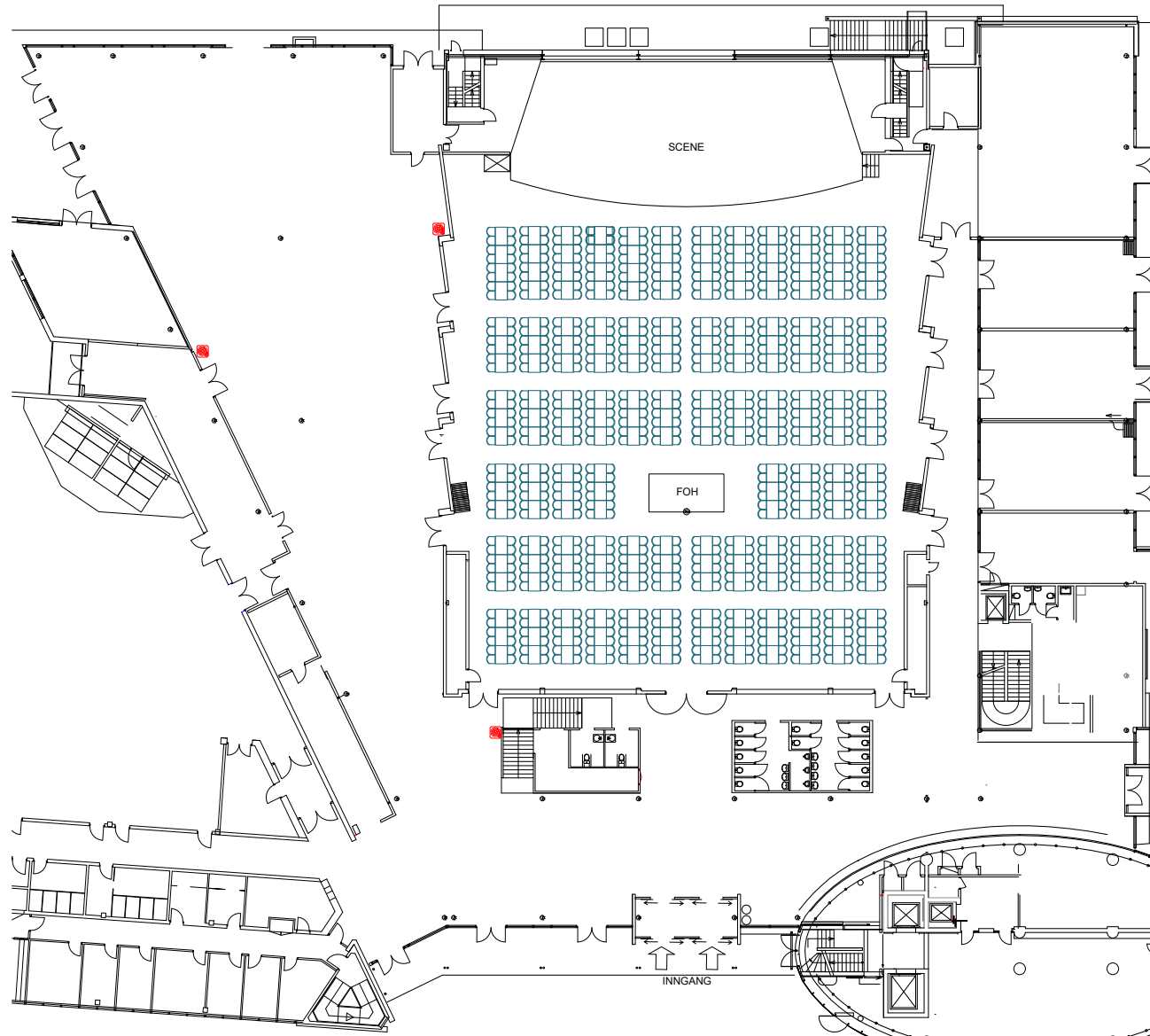

EXTRA LARGE MEETING ROOMS

Storsal A+ B, IMI Forum

Area: 1020 m²

Capacity: 194 pax

Set up: Rectangular tables - Corona

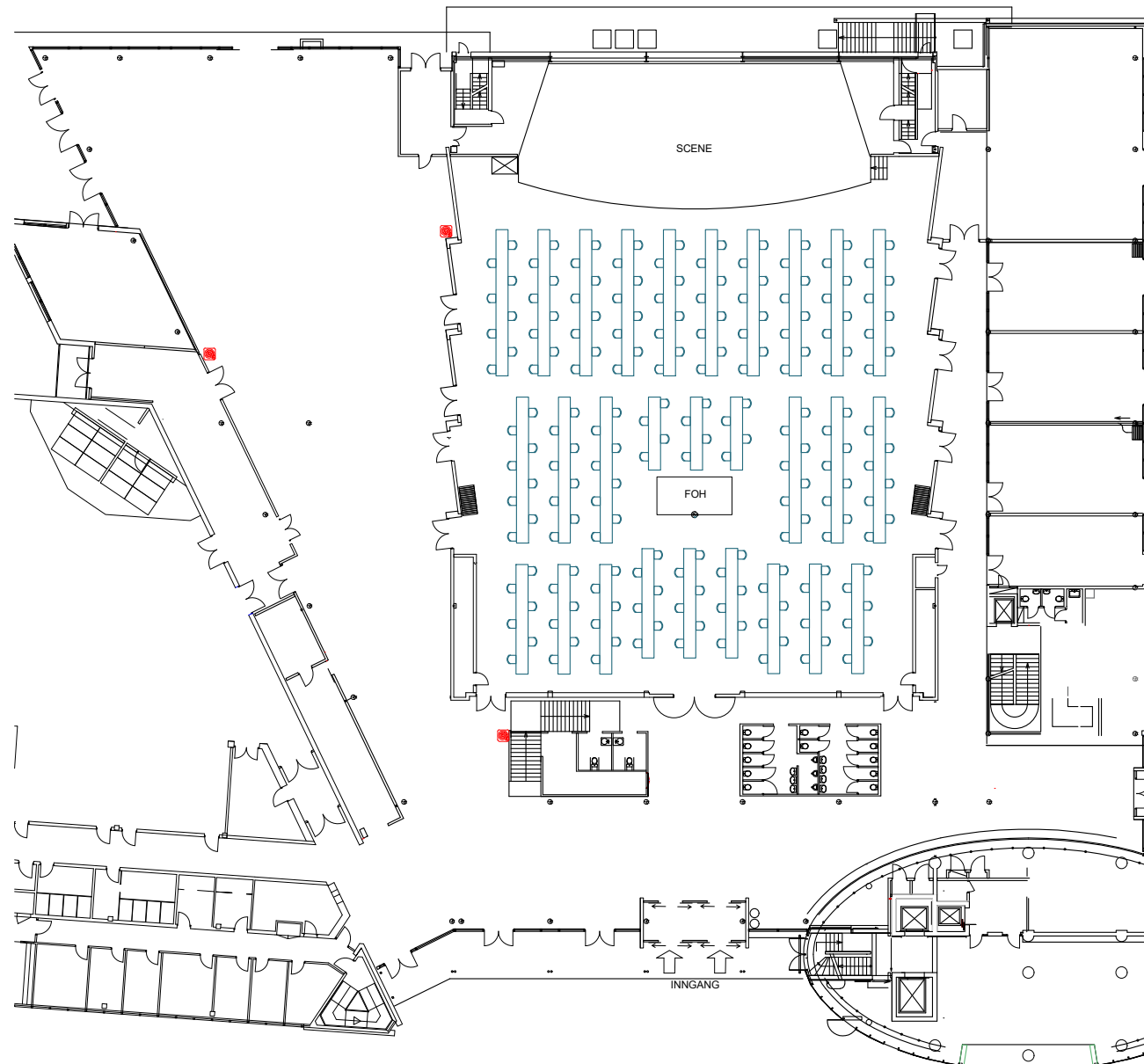

EXTRA LARGE MEETING ROOMS

Storsal A+ B, IMI Forum

Area: 1020 m²

Capacity: 560 pax

Set up: Round tables

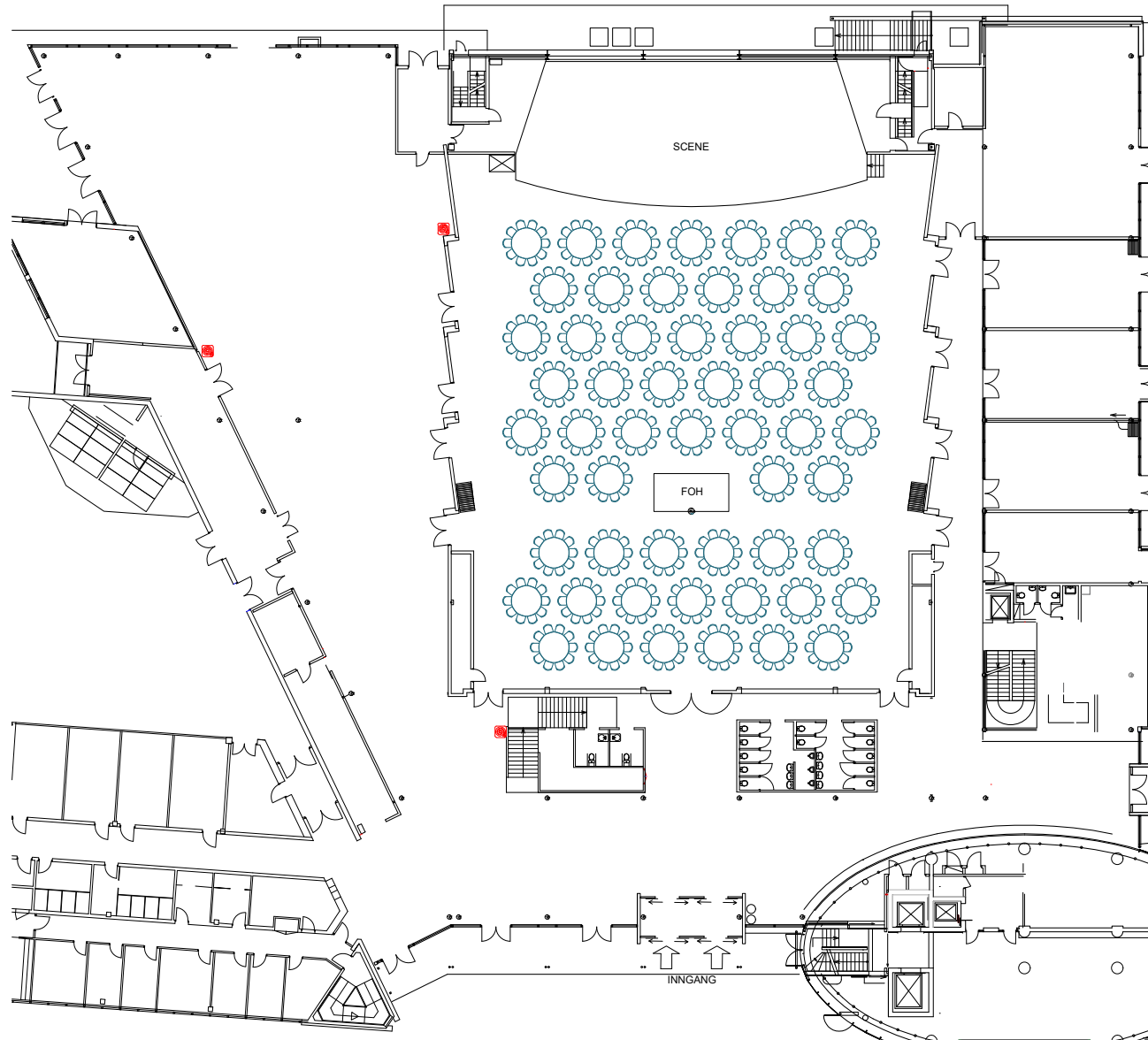

EXTRA LARGE MEETING ROOMS

Storsal A+ B, IMI Forum

Area: 1020 m²

Capacity: 260 pax

Set up: Round tables - Corona

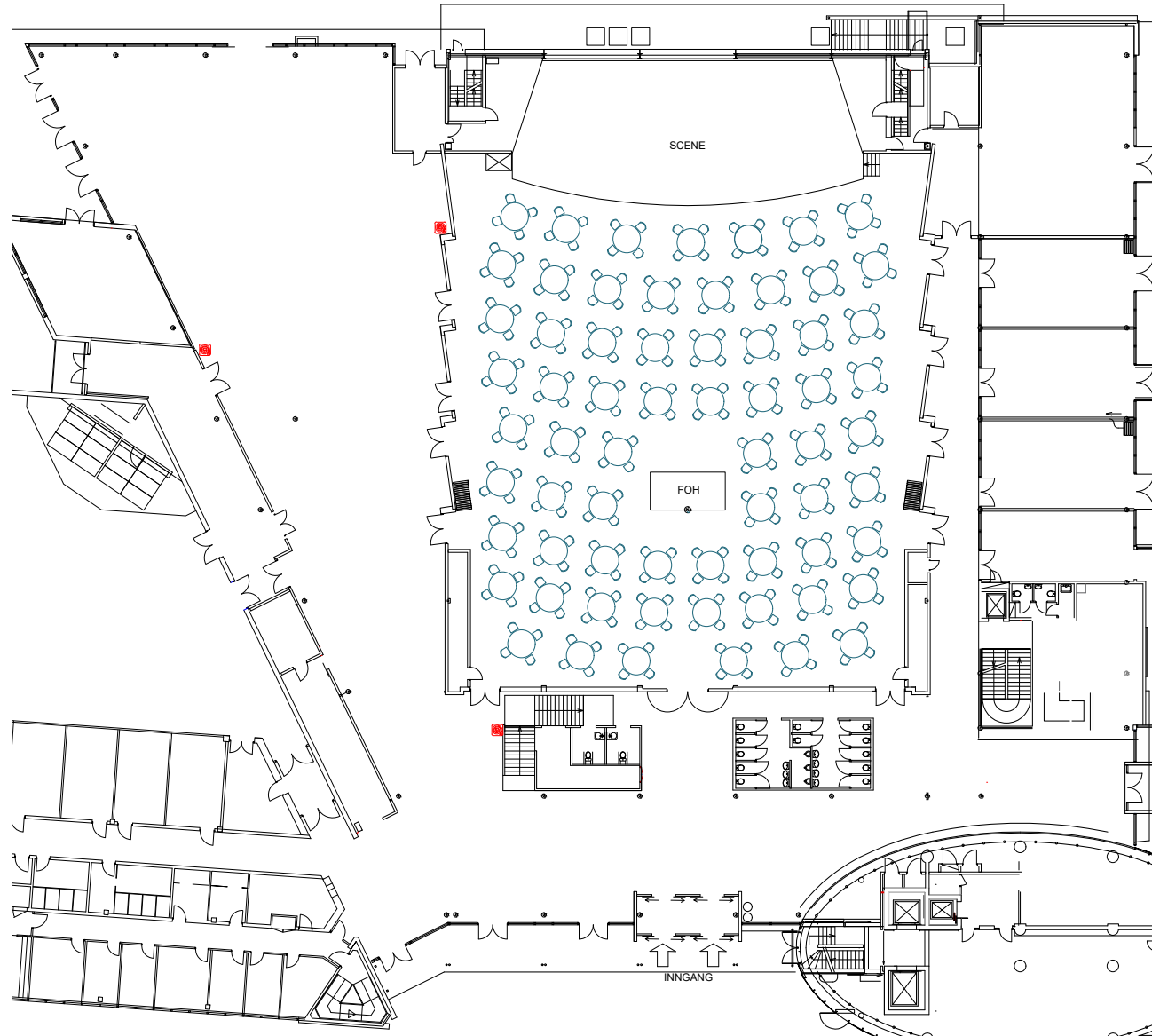

STORSAL A + B, IMI Forum

Technical specifications

Network	N/A WLAN (N/A LAN)	Comments	6 camera multicamera production also included.
Projector	2 x Panasonic PT-EW630E (5500 ANSI/Lumen)		For full technical specification: https://imi-forum-6945bb.webflow.io/arrangorinfo
Back stage accommodation	None		
House lightning	30 profil, 20 fresnell, 50 PAR, 30 moving head, haze and Martin M1 lighting controller and more included		
House sound / PA equipment	6 inear, 6 wireless transmitter/ receiver, 6 inear, Digico SD12-96.8 Nexo Alpha Fullrange, 2 Alpha S2 sub, 6 Ps10 (downfill + delay), 2 Ps8 (frontfill) 12 monitors and more included		
Truss / ceiling hight	11x motorized truss over stage. N/A meter ceiling height x		
Stage	23,4x9,7 meter, 100 cm height (190 m2)		
Drapes	None		