

# EXTRA LARGE MEETING ROOMS

DNB Arena, Isflaten

**Area:** 1650 m<sup>2</sup>

**Capacity:** 1600 pax

**Set up:** Cinema

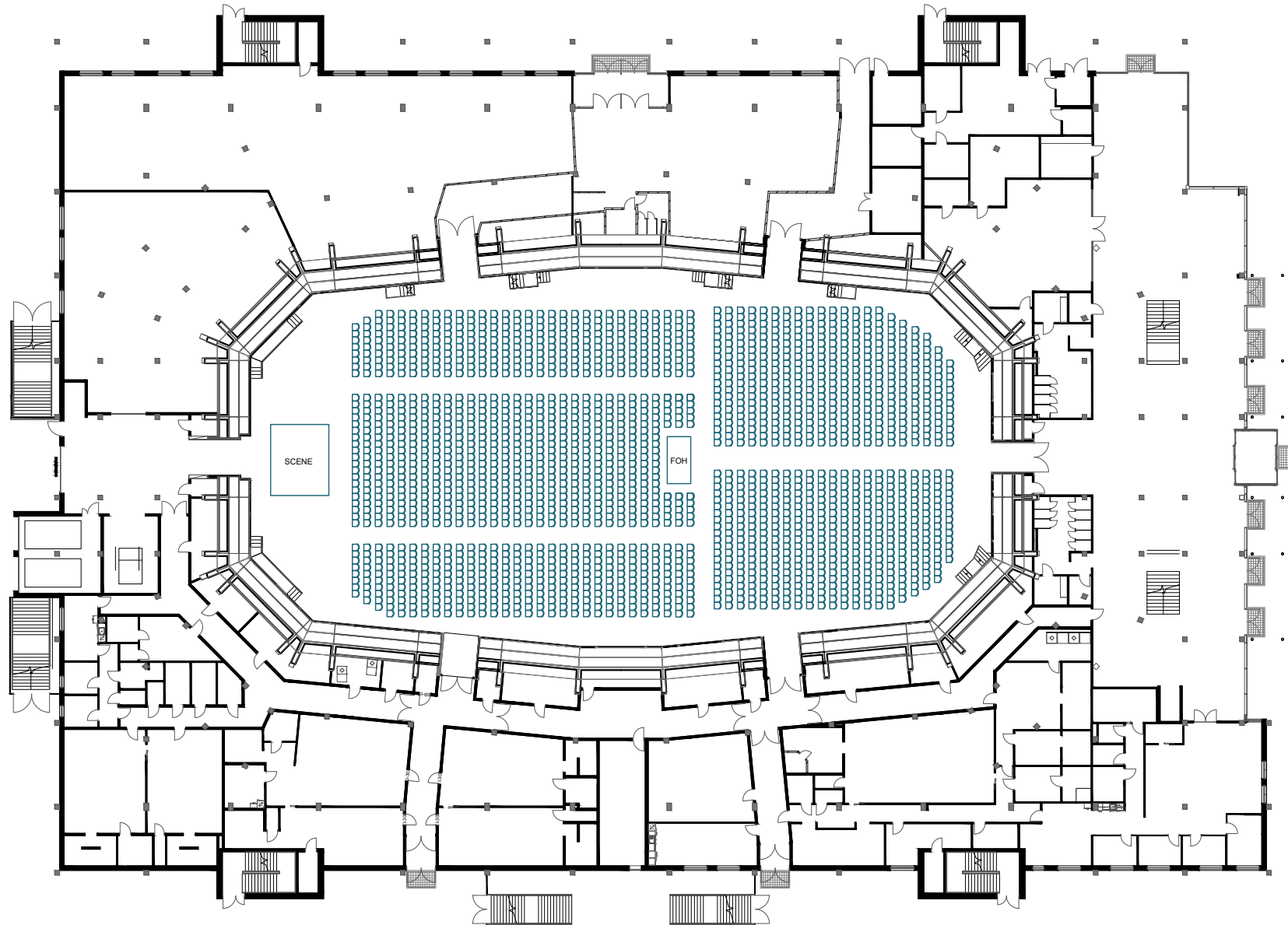

# EXTRA LARGE MEETING ROOMS

DNB Arena, Isflaten

**Area:** 1650 m<sup>2</sup>

**Capacity:** 432 pax

**Set up:** Cinema - Corona

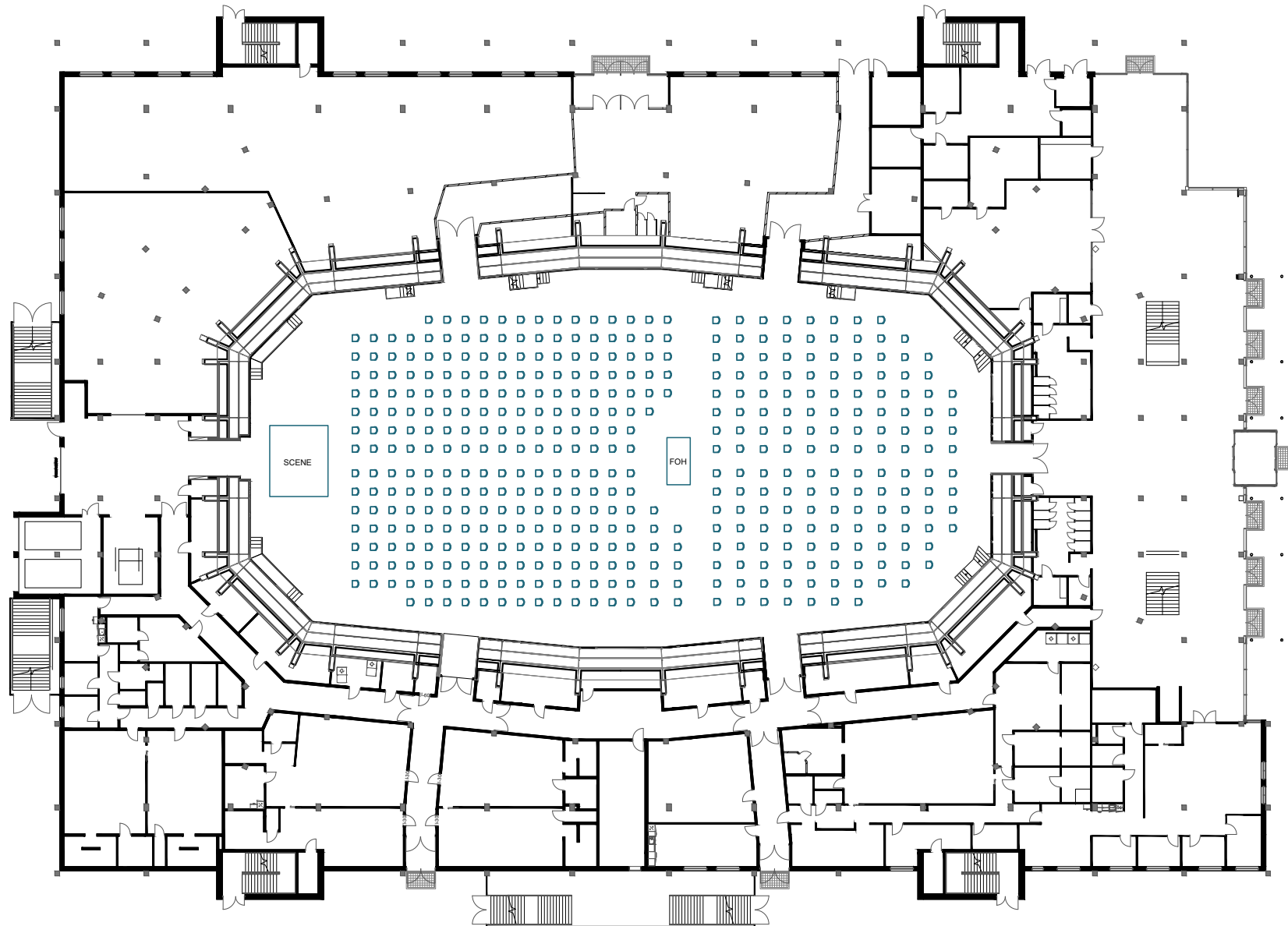

# EXTRA LARGE MEETING ROOMS

DNB Arena, Isflaten

**Area:** 1650 m<sup>2</sup>

**Capacity:** 1400 pax

**Set up:** Rectangular tables

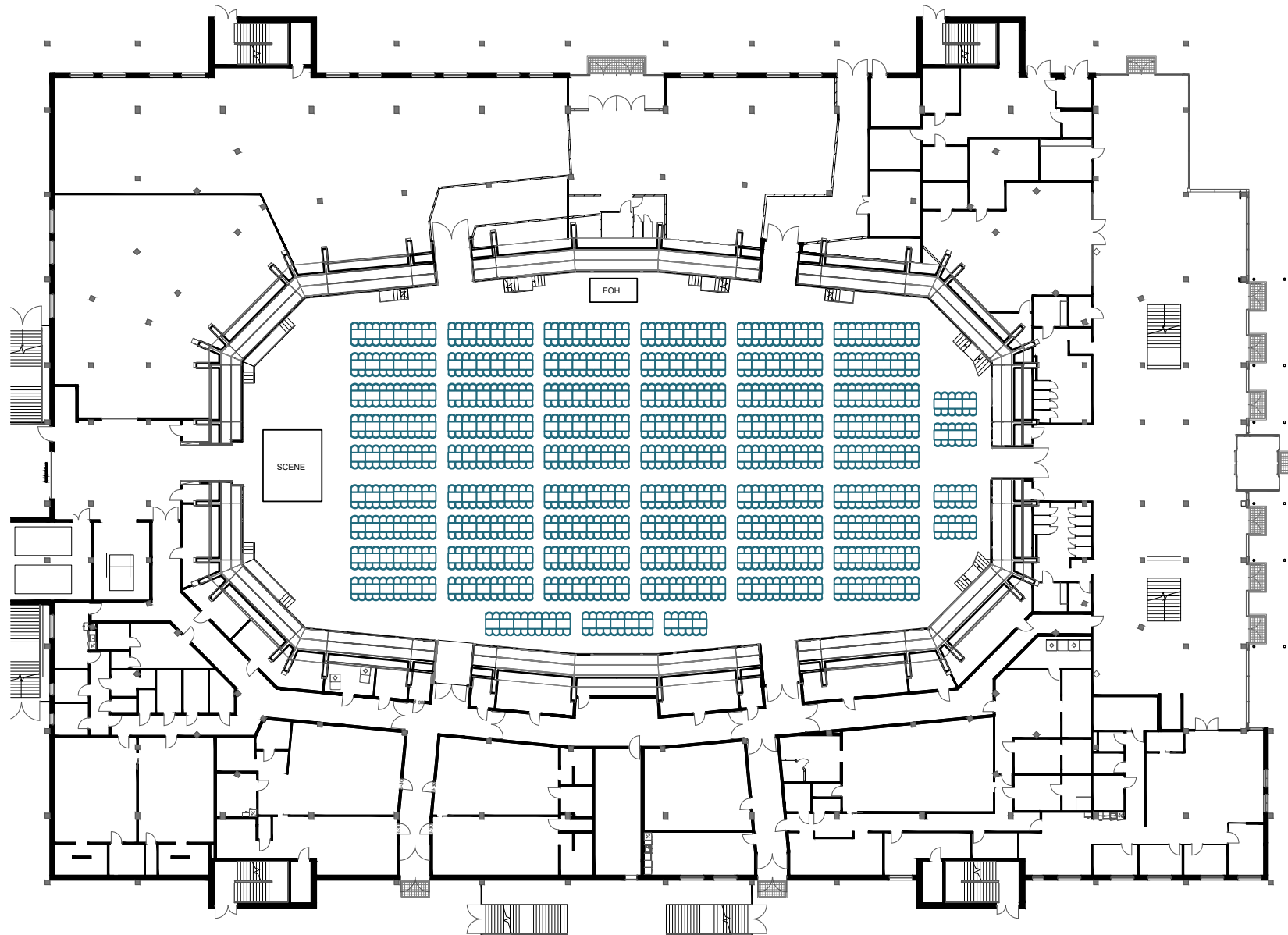

# EXTRA LARGE MEETING ROOMS

DNB Arena, Isflaten

**Area:** 1650 m<sup>2</sup>

**Capacity:** 316 pax

**Set up:** Rectangular tables - Corona

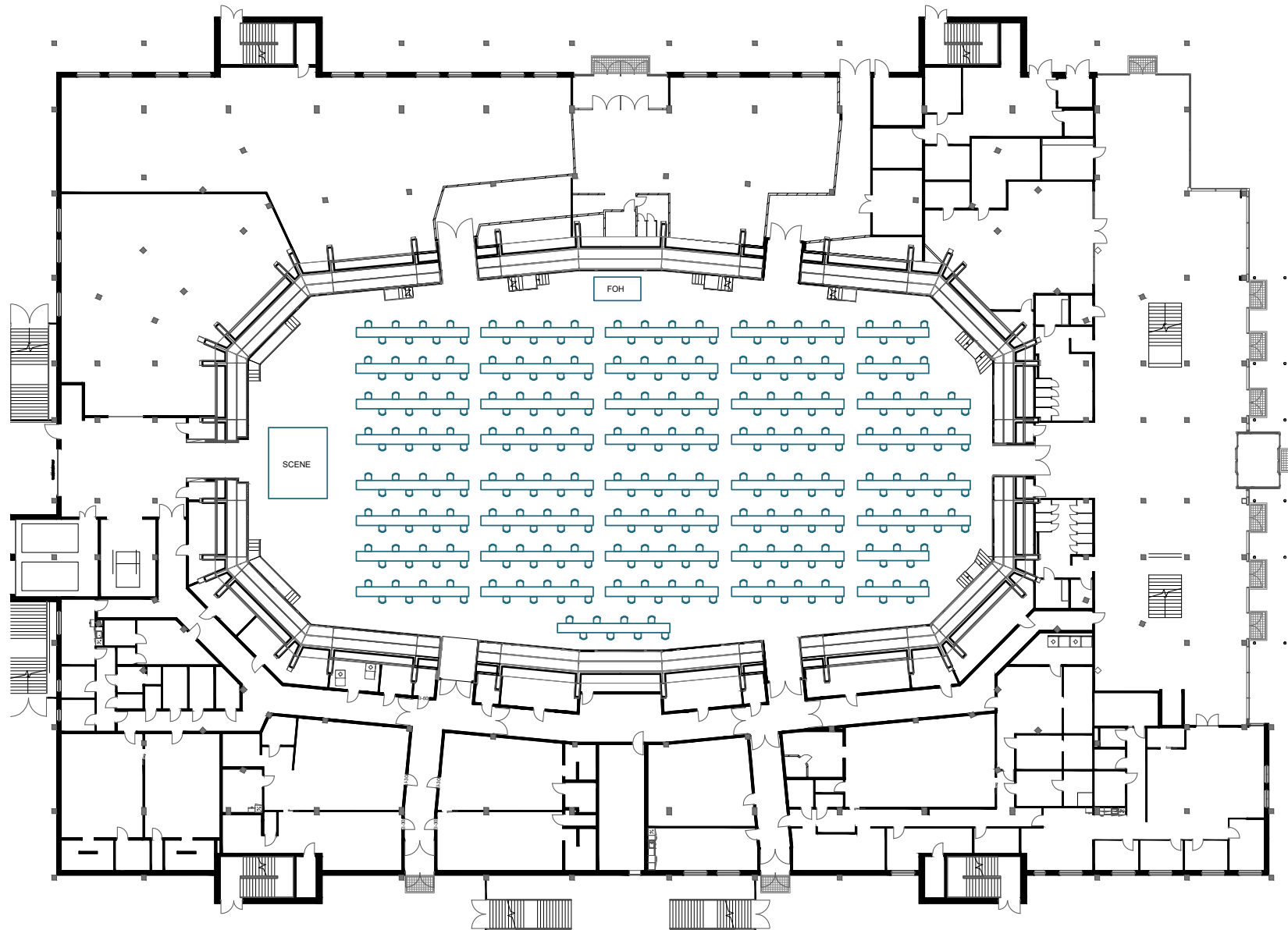

# EXTRA LARGE MEETING ROOMS

DNB Arena, Isflaten

**Area:** 1650 m<sup>2</sup>

**Capacity:** 1020 pax

**Set up:** Round tables

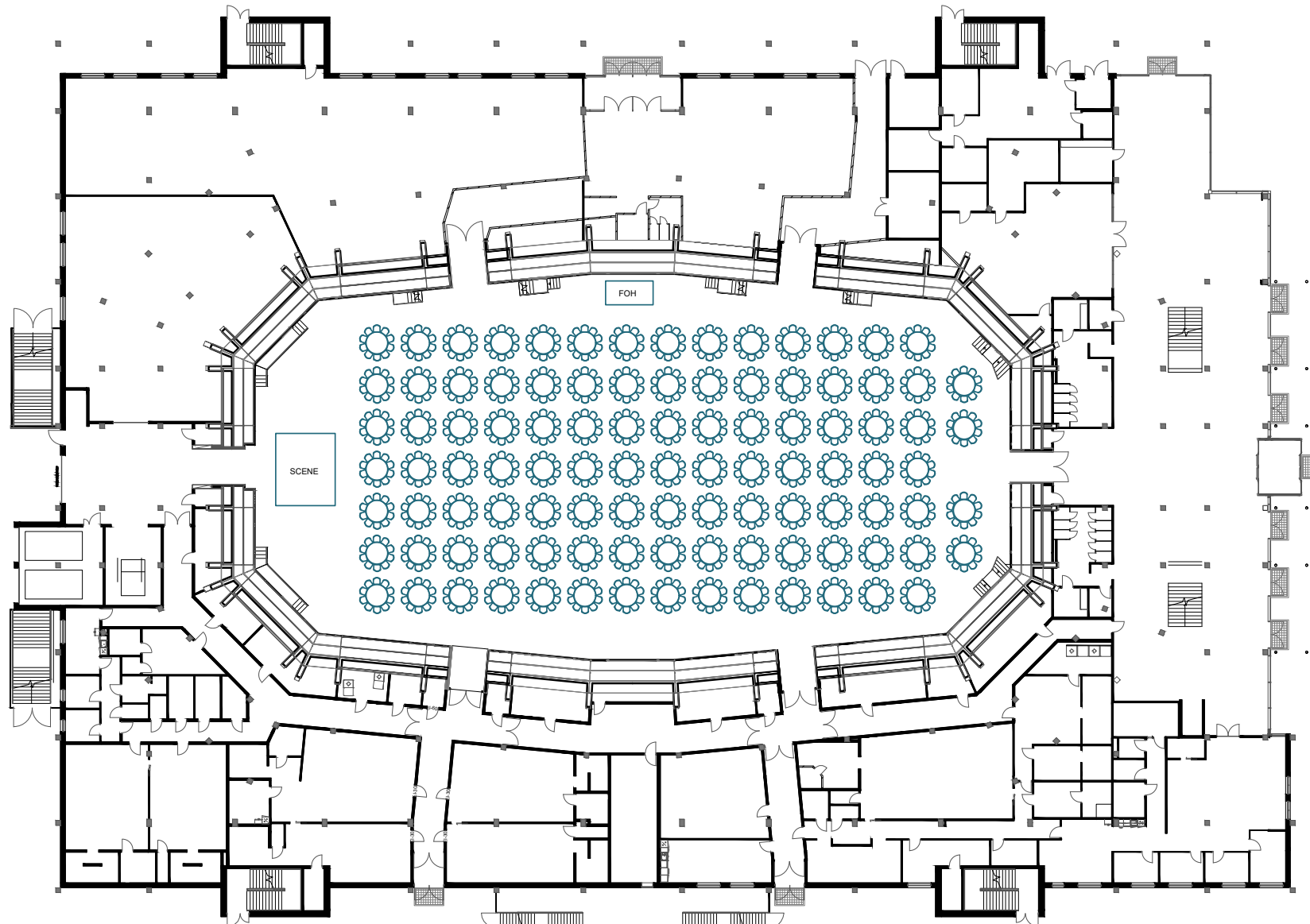

# EXTRA LARGE MEETING ROOMS

DNB Arena, Isflaten

Area: 1650 m<sup>2</sup>

Capacity: 288 pax

Set up: Round tables - Corona

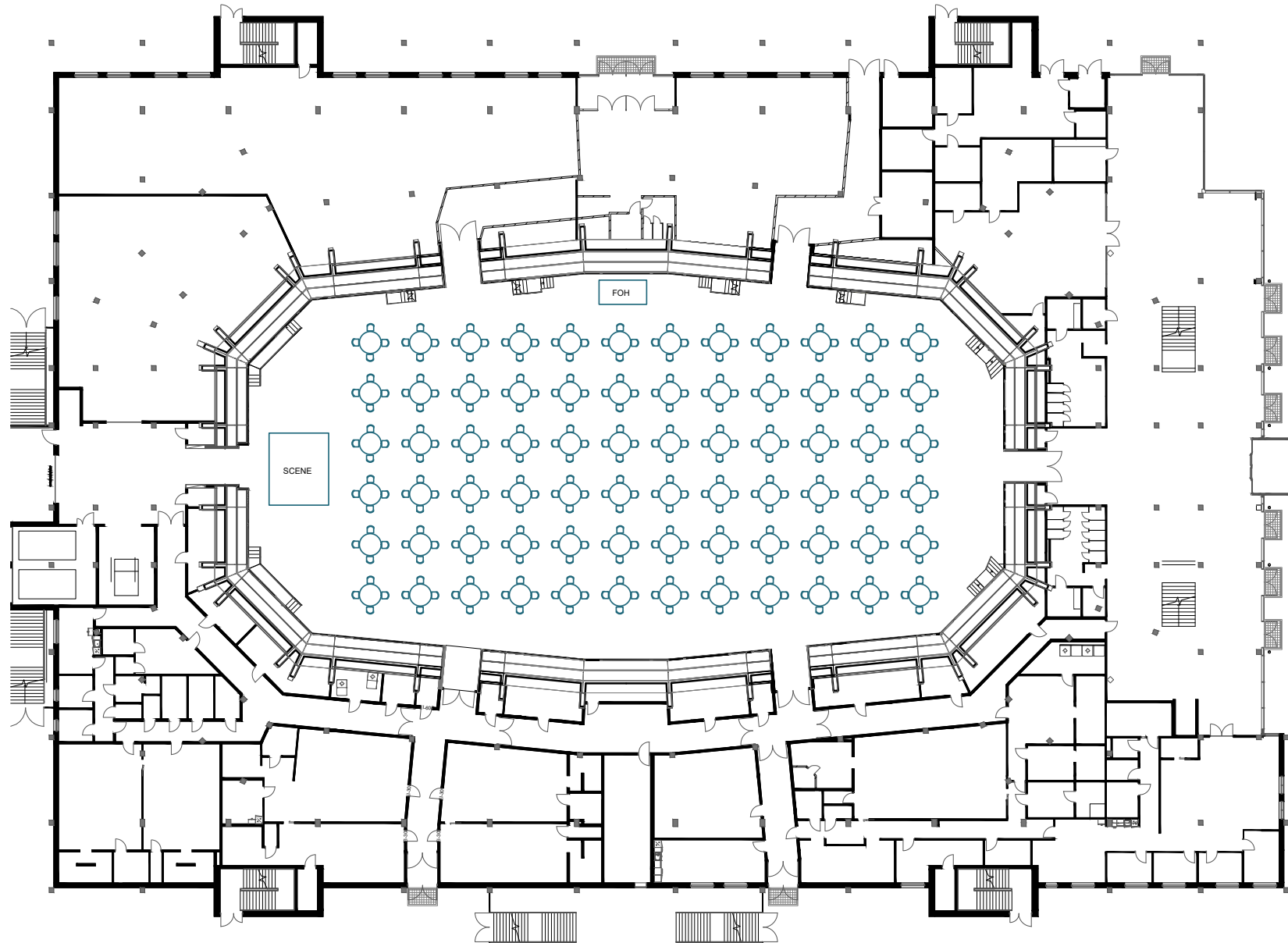

# DNB ARENA, ISFLATEN

## Technical specifications

<b>Network</b>	N/A WLAN (N/A LAN)	<b>Comments</b>	For full technical specification, contact Johnny Olsen at johnny@oilers.no
<b>Projector</b>	None		
<b>Back stage accommodation</b>	Dressing rooms located at same level as arena floor. Toilet and showers available		
<b>House lightning</b>	None		
<b>House sound / PA equipment</b>	None		
<b>Truss / ceiling hight</b>	No included truss. 10,5 meters (to media cube), 17 meters to ceiling rafters		
<b>Stage</b>	None		
<b>Drapes</b>	Rented locally		