

EXTRA LARGE MEETING ROOMS

Clarion Hotel Energy, Energy Hall 2

Area: 277 m²

Capacity: 280 pax

Set up: Cinema

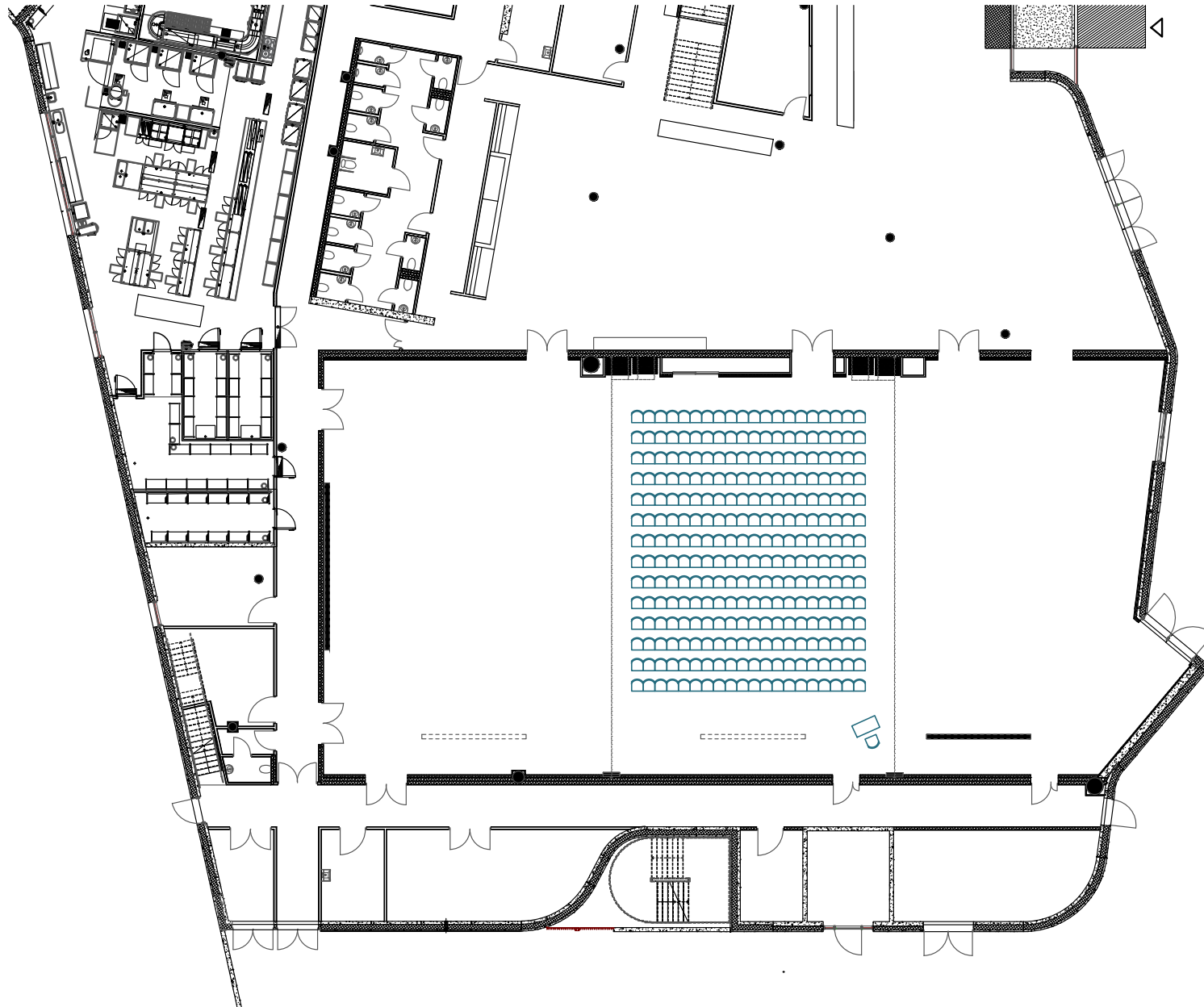

EXTRA LARGE MEETING ROOMS

Clarion Hotel Energy, Energy Hall 2

Area: 277 m²

Capacity: 72 pax

Set up: Cinema - Corona

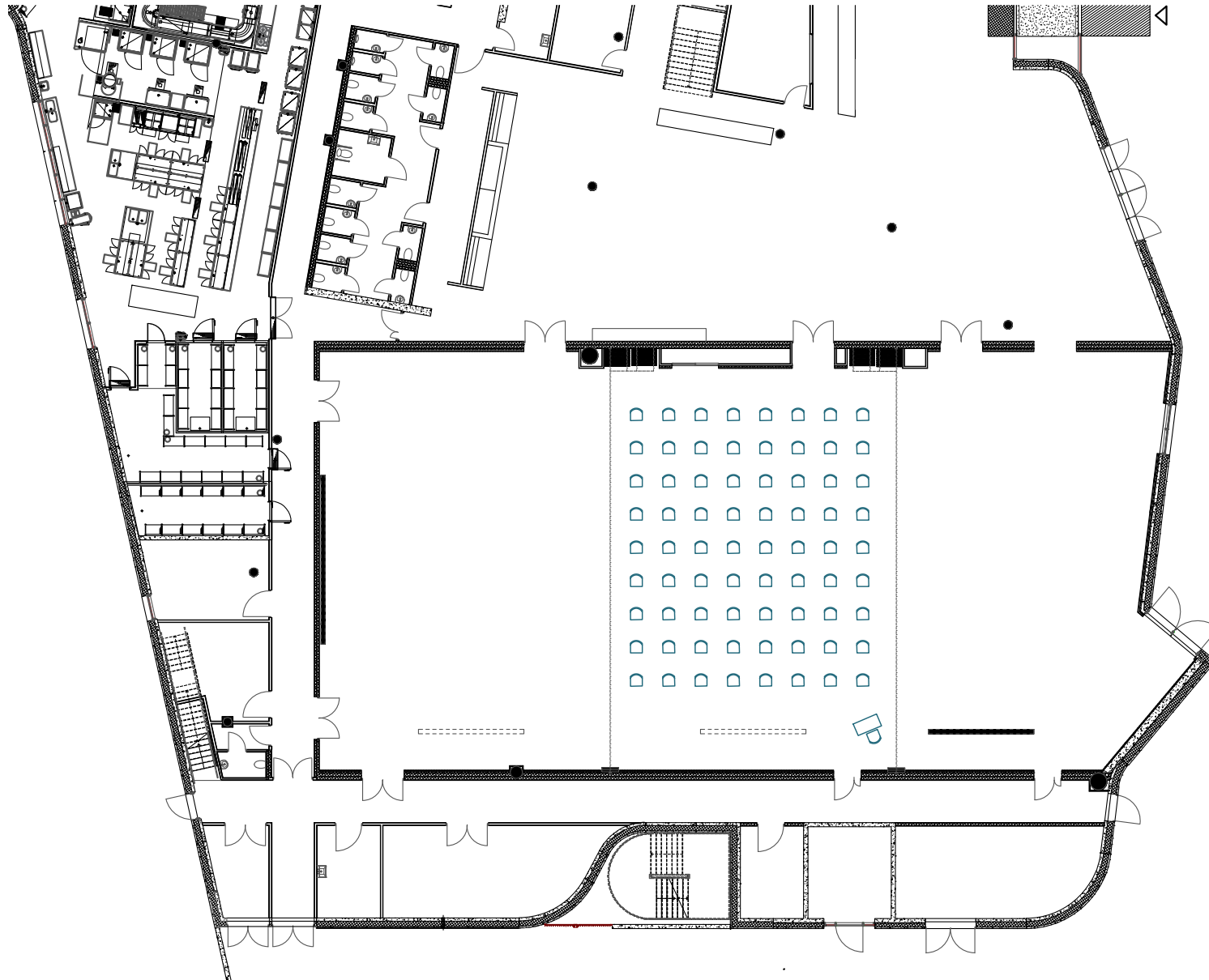

EXTRA LARGE MEETING ROOMS

Clarion Hotel Energy, Energy Hall 2

Area: 277 m²

Capacity: 168 pax

Set up: Rectangular tables



EXTRA LARGE MEETING ROOMS

Clarion Hotel Energy, Energy Hall 2

Area: 277 m²

Capacity: 60 pax

Set up: Rectangular tables - Corona

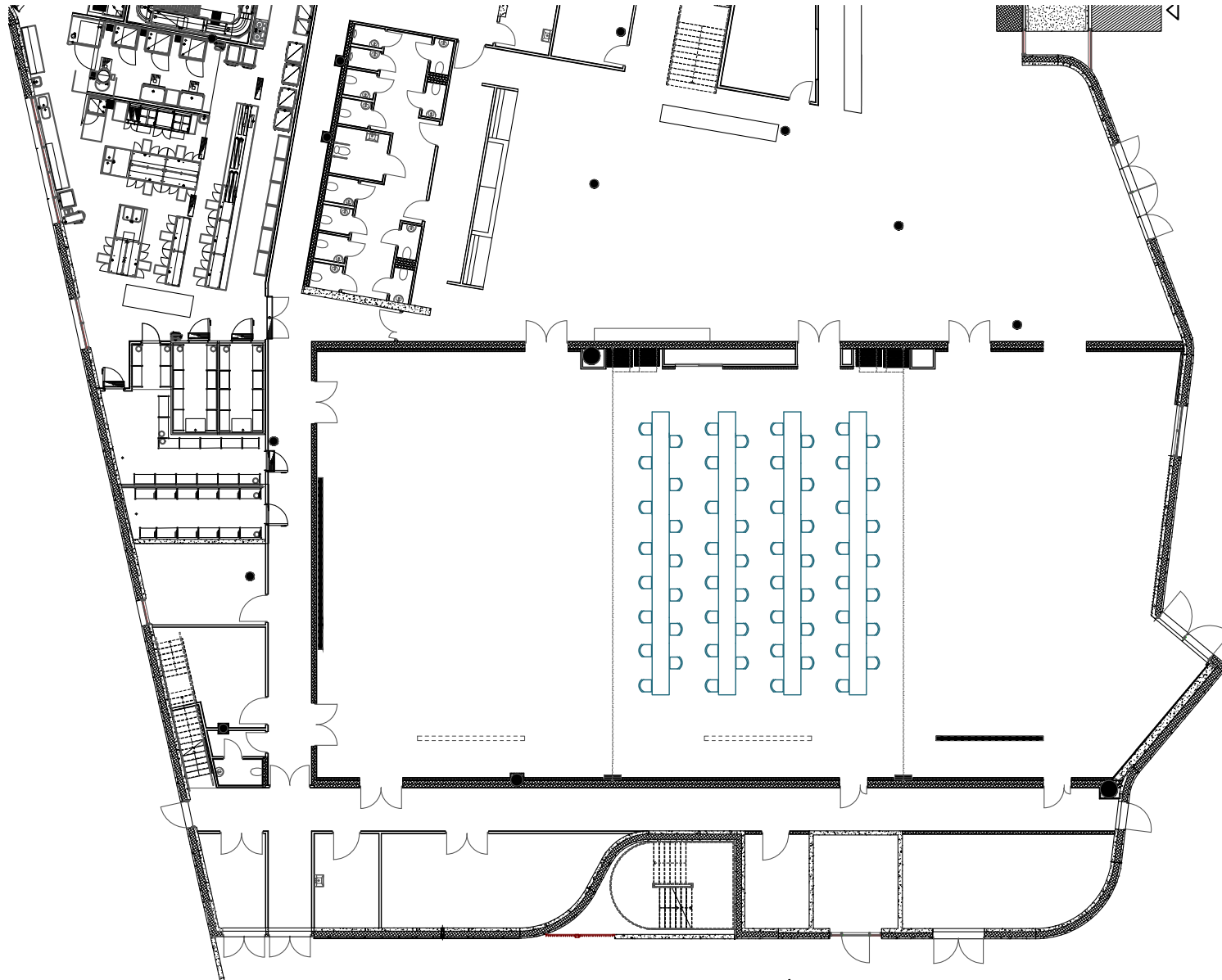

EXTRA LARGE MEETING ROOMS

Clarion Hotel Energy, Energy Hall 2

Area: 277 m²

Capacity: 110 pax

Set up: Round tables

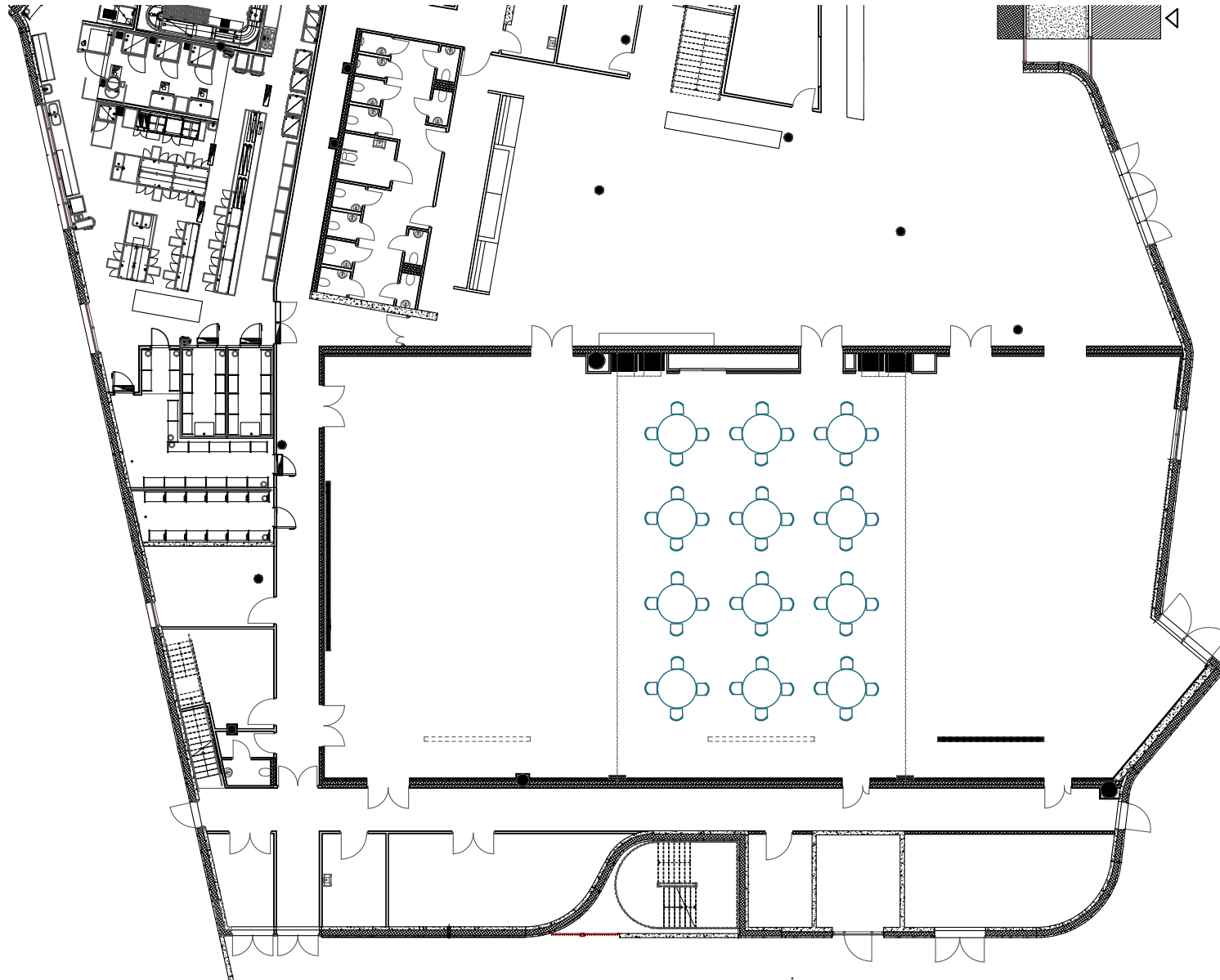

EXTRA LARGE MEETING ROOMS

Clarion Hotel Energy, Energy Hall 2

Area: 277 m²

Capacity: 48 pax

Set up: Round tables - Corona

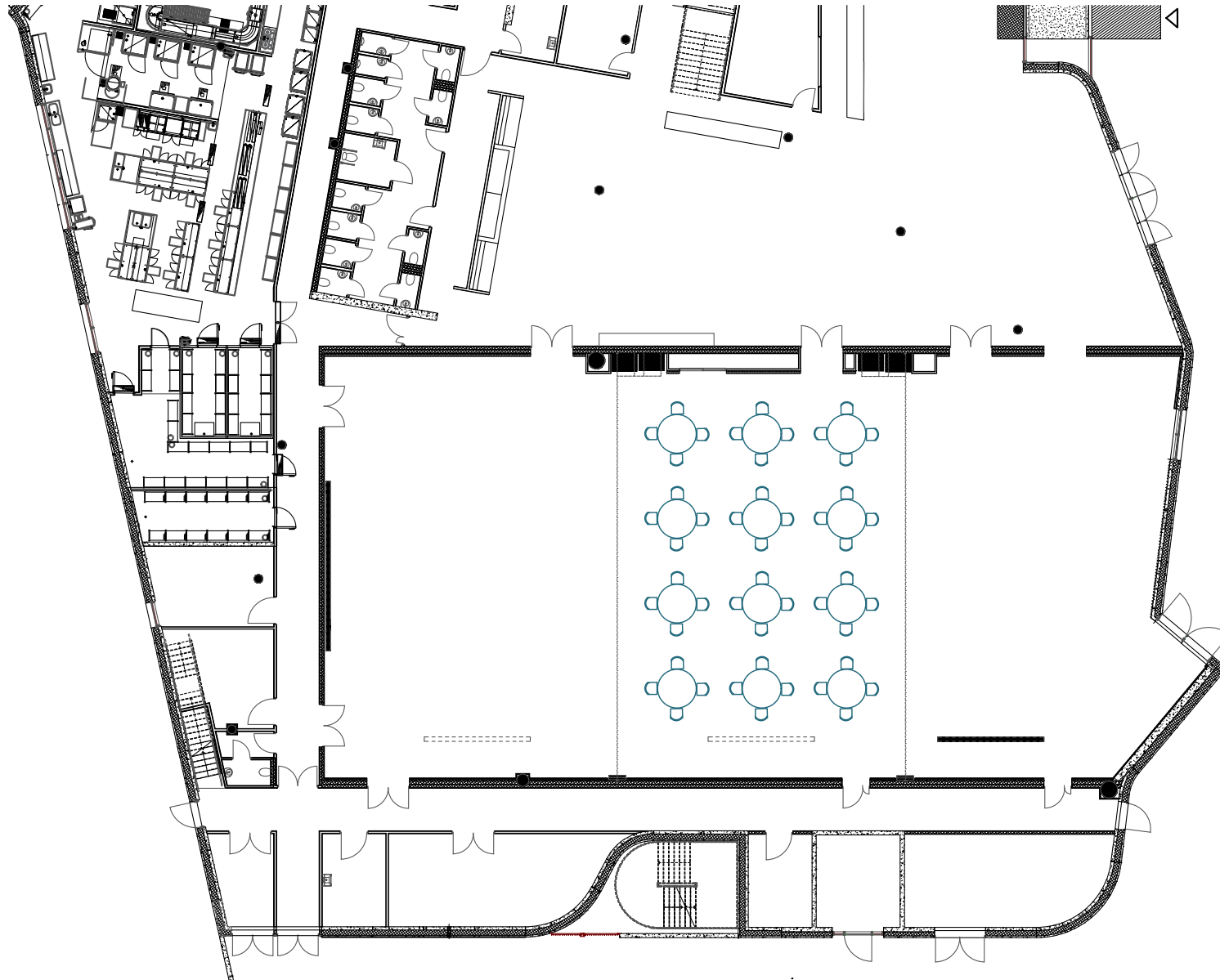

CLARION HOTEL ENERGY, ENERGY HALL 2

Technical specifications

Network	30/20 WLAN (200/200 LAN)	Comments	For full technical specification, contact Kjetil Sletten at kjetil.sletten@choice.no
Projector	2x Barco PHWU-81B (7500 ANSI/Lumen)		
Back stage accommodation	None		
House lightning	None		
House sound / PA equipment	None		
Truss / ceiling hight	2x truss. 6.5 meter height (floor to truss)		
Stage	None		
Drapes	None (no adjoining windows)		